

The Z-TRA of ELASTOTECNICA is a multiple connector or mechanical type connector used as an interface multi-connector in submersible transformers. Provides an aluminum hardware and oppressors that significantly minimize voltage drops, has a wide range of rope options for its interface with the transformer. It is supplied with enough silicones for each derivation. Its cover, caps, and sleeves made of peroxide cured EPDM and with high thicknesses, they make it highly insulating; Anticracking and environmentally resistant, provide tightness in all its parts and high performance; reaching a level of insulation resistance between 200 and 300 GΩ for more than 20 years guaranteed.

INTERFACE WITH THE TRANSFORMER (A)	CAPACITY ELECTRICAL
1/2 - 13 unc	600 V 200 A
5/8 - 11 unc	
5/8 - 18 unf	
3/4 - 10 unc	
3/4 - 11 unc	
3/4 - 16 unf	

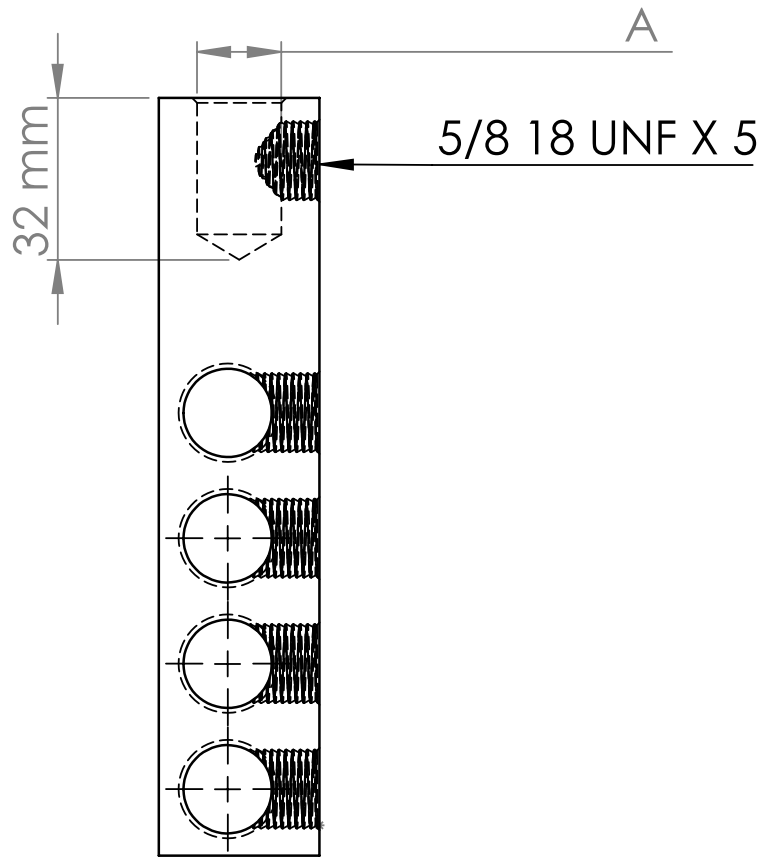

visit our  
online store

Carretera Ánimas - Coyotepec Km 4 S/N , Colonia Ixtapacalco, Coyotepec, Estado de México C.P. 54666  
[WWW.ELASTOTECNICA.COM.MX](http://WWW.ELASTOTECNICA.COM.MX)